

ENCLOSED Compact-THERM Systems



Compact-THERM
7-ft x 9-ft enclosed skid

EQUIPMENT FEATURES

You won't find this kind of quality anywhere else! SOIL-THERM Enclosed Systems represent the finest quality, hardest working, most energy efficient thermal remediation systems on the market! Here are some of the key features of these systems:

Space Saving Design: We've installed a 500 scfm Compact-THERM system inside an enclosure and its still 30% smaller than the competition's monster-sized systems! These systems are sharp looking, quiet, and are good neighbors during your remediation site cleanup operations!

Energy Efficient Burner Technology. While all the others try using oven burner technology, you're going to have lower fuel bills using SOIL-THERM's Jet-THERM burner oxidizer systems. Jet-THERM burners meet low NOx requirements.

Powerful Touchscreen. The 8" TFT Color touchscreen provides complete status data operation, operating information, troubleshooting guide & operating hints, and datalogging to a 1GB data memory card. Brilliant graphics!

All Stainless Steel Vapor Piping & Water KO. This feature alone is worth a ton of money that you don't find with others. All stainless steel, prevents rusting, internal piping degradation, and ensures long equipment life for many years.

Quality Construction: When it comes to quality, SOIL-THERM is the leader. Premium components, careful attention to code and details, and excellent designs will meet your project needs. Custom requests are also welcome!



5310 Derry Ave, Unit C
Agoura Hills, CA 91301-4509
(818) 706-9875 FAX (818) 706-2145



www.soiltherm.com

ENCLOSED Compact-THERM Systems

Each **Compact-THERM** Enclosed System features a complete locking enclosure for a powerful 500 scfm thermal/catalytic SVE oxidizer system. Everything is mounted on this system to begin SVE operations!

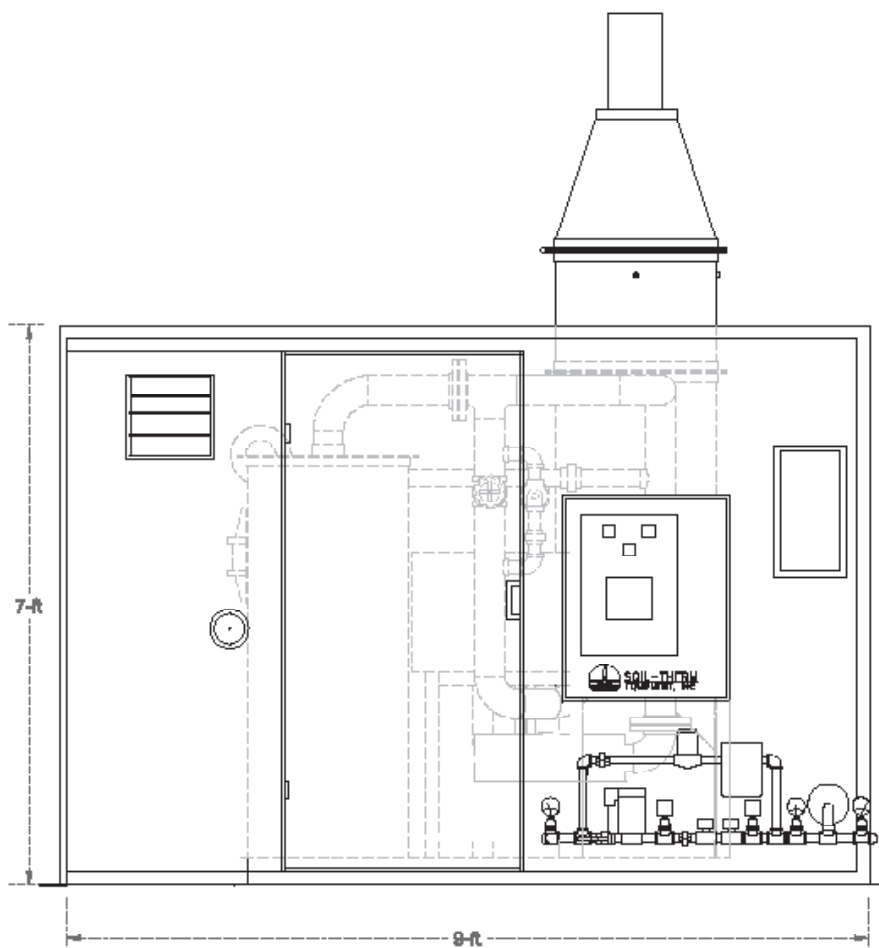

Equipment Specifications

VOC Processing: to 12,000 ppmv
Destruction Efficiency: >99%
VOC's /hour (max): 110 #/hour
Size: 6-ft x 6-ft x 13-ft (H)
Weight: ~4000 lbs
Well Vapor Connect: 4"

Electrical: 230VAC, 3-phase, 60Hz, 100A
(phase converters available)
Natural Gas: 3/4", 750 cfh @ 2-5 psig supply
Propane: 3/4", 350 cfh @ 2-5 psig vapor
Stack Height: 13-ft



SOIL-THERM
EQUIPMENT, INC.

5310 Derry Ave, Unit C
Agoura Hills, CA 91301-4509

www.soiltherm.com (818) 706-9875 FAX (818) 706-2145